



The Cyber Blog India

Digital Parenting Guide: Setting up Google Family Link App

Raj Pagariya

July 09, 2020

Over the course of the last four months, we have received a large number of queries from parents who are worried about their children's internet usage. Most of these queries are related to common issues that parents face. Riding on this motivation, I will be writing a series of articles under the series **Digital Parenting Guide**. This the first article in this series and I will discuss how you can set up Google Family Link app for you and your child.

What is Google Family Link?

Google Family Link helps parents in setting up digital ground rules for their children when they are playing, learning, or exploring the internet. Initially launched in March 2017, it allows parents to:

- Guide their children to good content
- View and manage the applications they are installing
- Keep a check on their screen time (set limits and lock the device)
- Check their live location

There are two applications: [Google Family Link for parents](#) and [Google Family Link for children and teens](#). The former has to be installed on your mobile phone while the latter needs to be installed on your child's device.

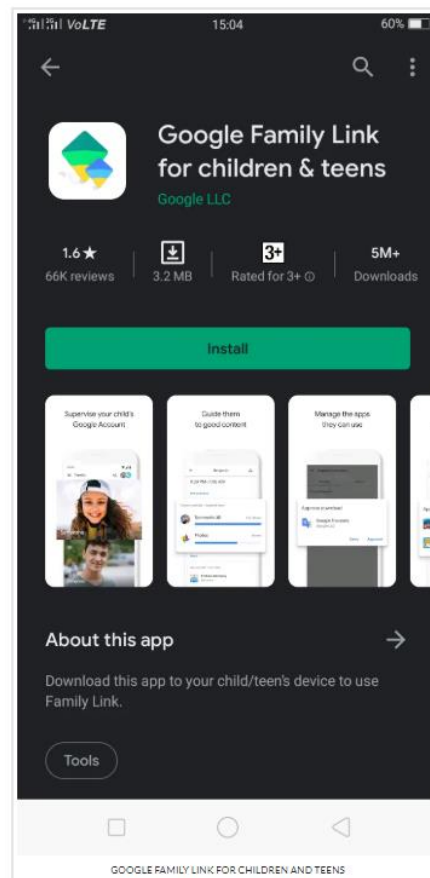
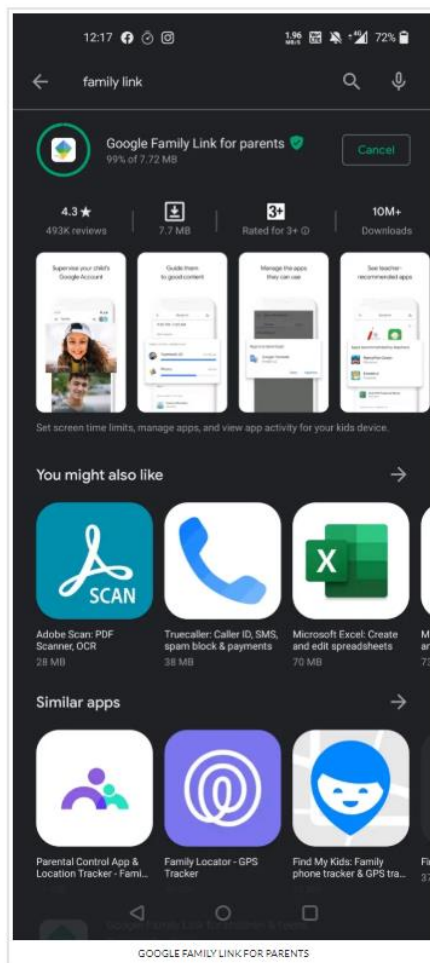

How to set up Google Family Link?

Starting with, you need both the devices: yours as well as your child's. Install the parents' app on your device and children's app on your child's device.

On your device, open the Google Family Link application. After initial welcome screens, it asks you to select a Google account. Please note that you cannot use organisational email addresses in this application. Select your email address to proceed.

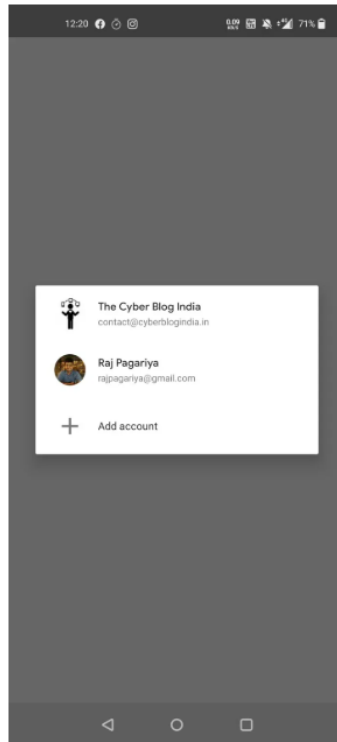

After selecting your account, the application asks whether this application will be used by a parent or child/teenager. Select *Parent*.

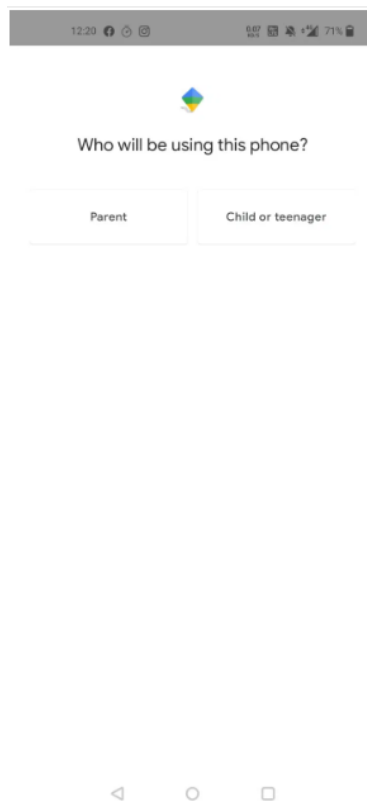

After this, it asks you to ensure that your child's device is nearby. It then seeks confirmation: *ready to be a family manager?* Select the *I'M READY* button to continue.

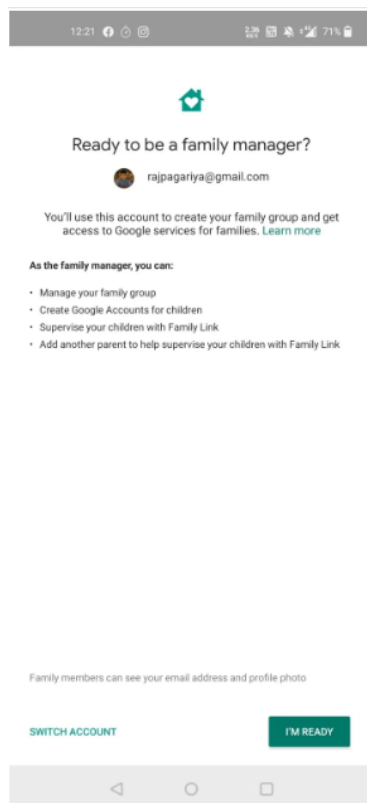

The application inquires if your child has an email address. It will show a code of 9 characters that you are supposed to enter on the child's device.

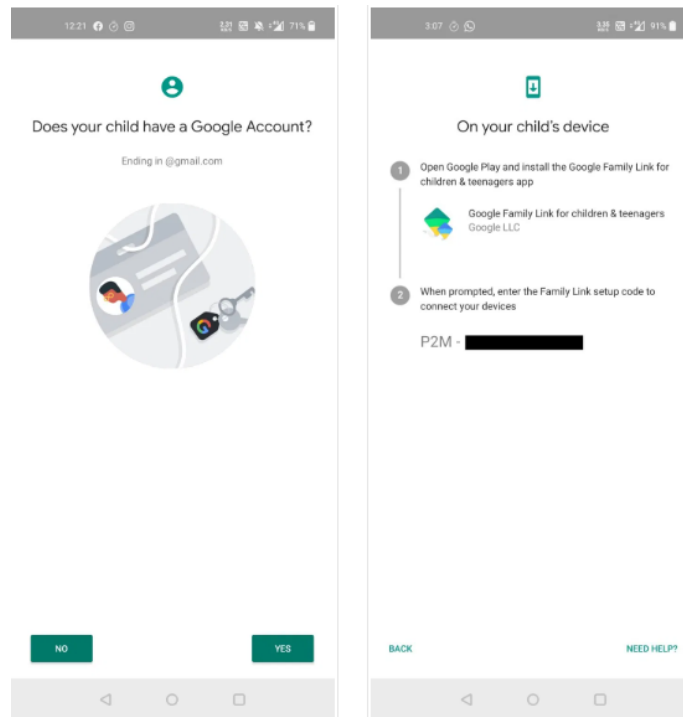

On your child's device, open the Google Family Link for children and teens application. The application prompts you to select the device and email account for supervision. Enter the code when asked.

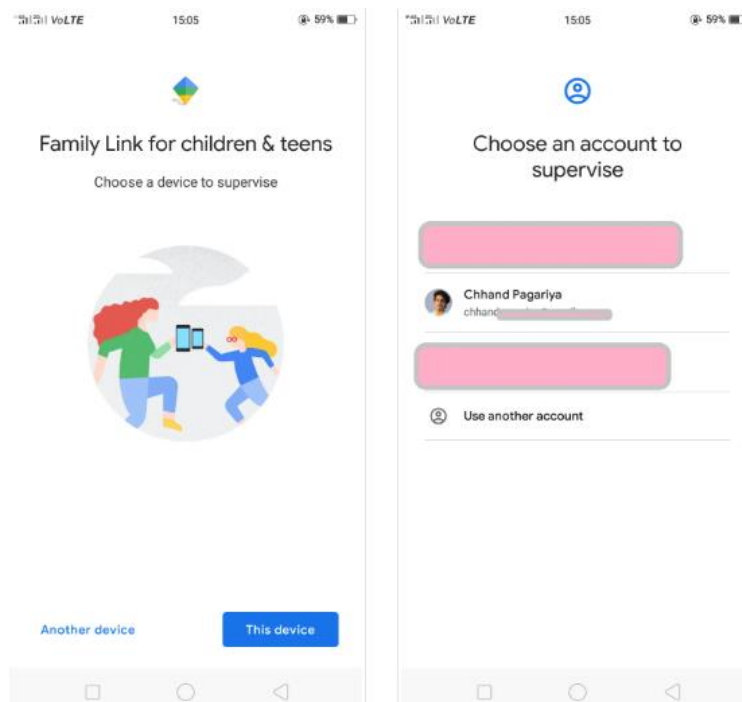

Next, the application informs your child that you want to set up Family Link supervision on their device. To confirm, the child is required to enter the password

for his/her Google account. It also shares the details about what parents can see/do and what they cannot. Then, the app asks the child whether they want to allow supervision or not. Once allowed, the Profile Manager should be activated on the child's mobile device.

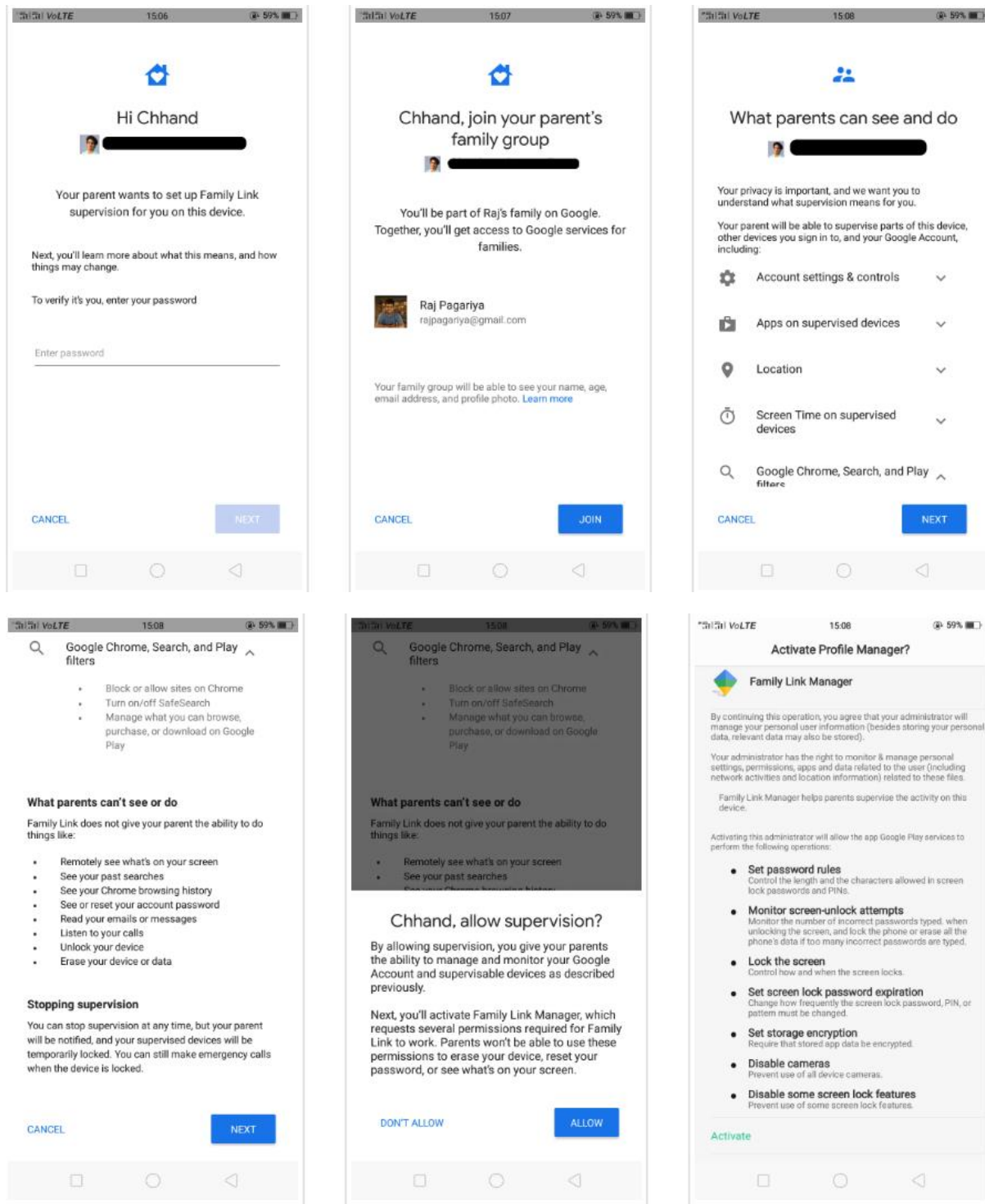

Now, the application requires a name to be set up for the device. It asks to review the existing applications which are classified based on their age ratings.

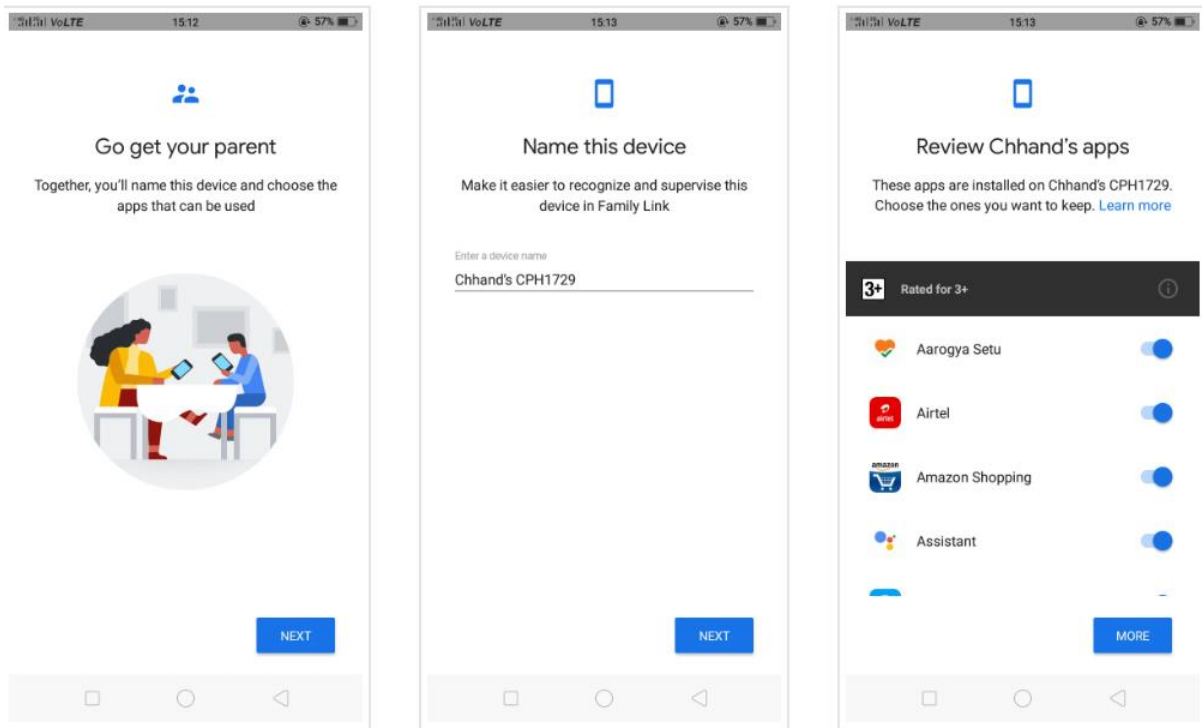

After all these steps, set up on the child's device is done and you will be redirected to the application's home screen.

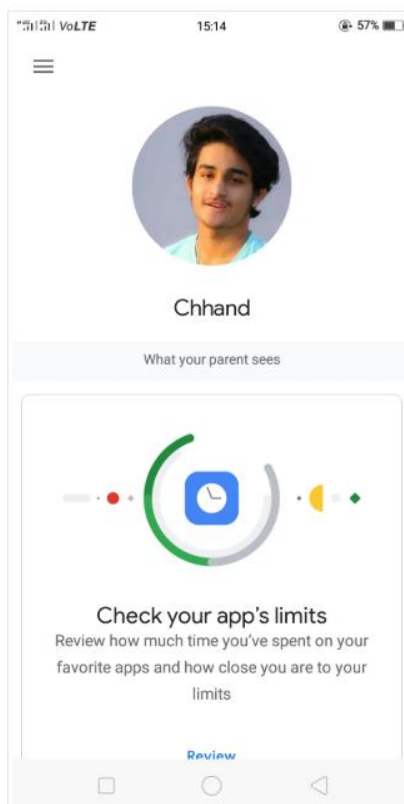

After the setup is completed on the child's device, the application on your device will ask you to confirm the account you wish to supervise. Meanwhile, you should

also receive an email informing you that your child has joined your family group. As far as content filtering is concerned, I would recommend you to go with the default settings if you are the first-time user. I have found them efficient so far.

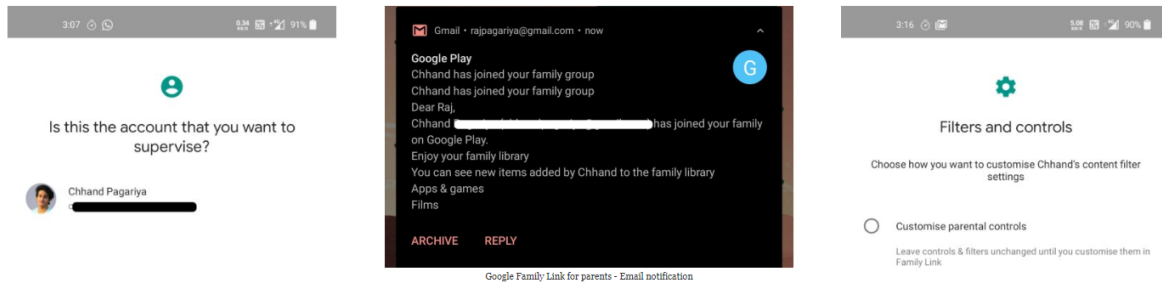

And that's all. You should be able to see the application's home screen on your mobile device. From here, you can check all the information and make necessary changes as required. For example, you can see the live location of the device under supervision in the lower half of the screenshot shown below.

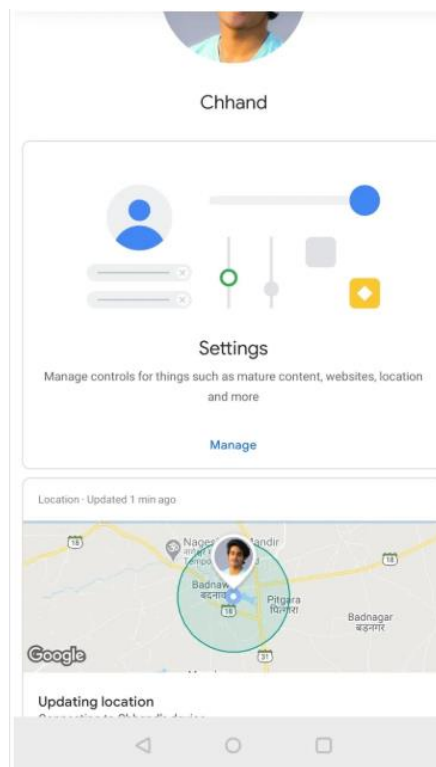

If you encounter any issues while setting up this application, feel free to get in touch with us. You can reach out to us via our WhatsApp Helpline at [+91 9340337396](tel:+919340337396), email at contact@cyberblogindia.in, or any social media platform. Stay tuned for our upcoming posts in the *Digital Parenting Guide* series.